

# QUICK START GUIDE

AUGUST 2018  
PART NO. 25010301

## intelliGen™ Refrigeration Controller

### PRIOR ASSEMBLY NEEDED

Please keep these instructions for future reference.  
Equipment assembly and wiring is required before using this guide.  
Please make sure control circuit transformer is properly setup.

For assembly, please consult intelliGen installation & operation manual.

### IMPORTANT!

Control transformers come with the voltage tap on 240V (as shown).  
If your site has less than 215VAC, the tap will need to be moved to 208V  
in order to ensure 25VAC to 29VAC power to IntelliGen board.

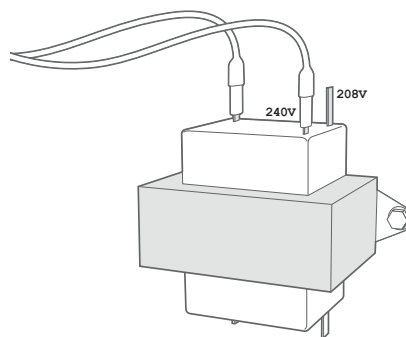

### Legend

Long Name	Abbrev. Name
Evap/Evaporator	EV
Set-Point	SP
Auxiliary	AUX
Temperature/Temp	TEMP
Calibration	CALIB
Electronic Expansion Valve	EXV
Condensing Unit	CU
Compressor	COMP

### U.S. Customer Service

**Normal Business Hours** - 8:00 AM - 8:00 PM EDT  
(800) 537-7775

**After Hours** (After 5:00 PM EDT, weekends and holidays)  
(877) 482-7238

[heatcraft.com/intelligen/support](http://heatcraft.com/intelligen/support)  
[SESweb@heatcraft.com](mailto:SESweb@heatcraft.com)

# intelliGen REFRIGERATION CONTROLLER

## Get to know the intelliGen Refrigeration Controller (iRC)

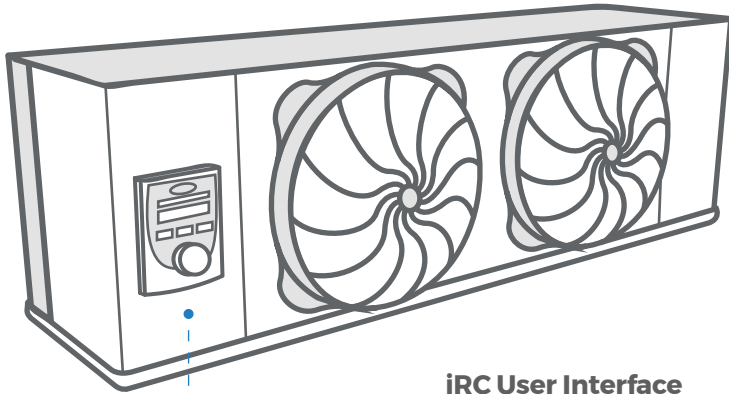

### iRC User Interface

You can find the User Interface (iRC UI) attached to each unit.\*

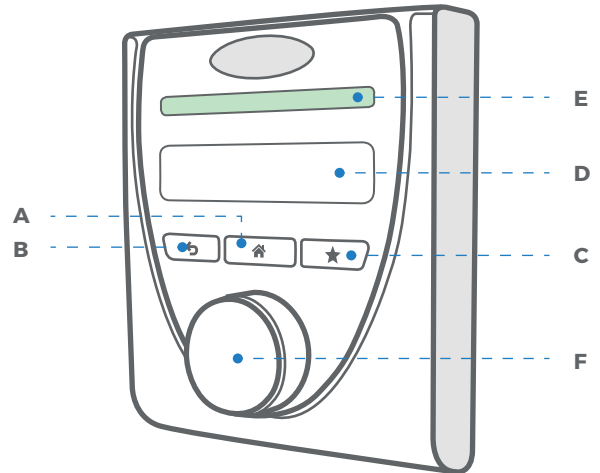

## HOW TO NAVIGATE?

- A. Home Button:** Press to go back to Main Menu
- B. Back Button:** Press to go back to Previous Menu
- C. Favorites Button:** Press to go to your Favorites
- D. OLED Screen:** Shows the content like temperature, parameters and others.
- E. LED Status Light Bar:** Indicates the current status of all specific evaporators on the system (See below).
- F. Knob / Enter Button:** Rotate the knob left and right to navigate between Menu Options. Press the knob to ENTER.

## LED Status Light Bar

### GREEN



#### LED GREEN STATIC

The System or EV does not have any anomalies/issues.

### RED



#### LED RED STATIC

The System or EV has an Alarm.

#### LED RED FLASHING

The EV Unit where the Alarm originated.

### YELLOW



#### LED YELLOW STATIC

The System or EV has an Error.

#### LED YELLOW FLASHING

The EV Unit where the Error originated.

### WHITE



#### LED WHITE STATIC

The EV Unit is being identified.

### NO LED ON



The EV Unit is currently OFF.

Scan QR code to view the Quick Start Configuration video.



\* Figure shows a Low Profile unit cooler; location might vary on other units.

# QUICK SETUP FROM iRC UI

## STEP 1. Enter Expert PIN

\_\_\_\_\_

ENTER EXPERT PIN  
X X X X X X

First digit in PIN automatically flashes for edit. Turn dial to change first PIN digit 0-9. Push Enter to choose digit. Repeat with all digits.

## STEP 2. Select Configuration Mode

\_\_\_\_\_

CONFIG FROM? EV

Select EV to proceed with configuring the system from the iRC UI.

## STEP 3A. Equipment Discovery

\_\_\_\_\_

DISCOVERING  
Equipment...

After Configuration Mode is selected as 'EV', the iRC will automatically attempt to discover all units in the system.

## STEP 3B. Equipment Discovery

\_\_\_\_\_

#EV FOUND  
Continue?

After polling for connected units, the iRC UI will display the number of EV that are found to be wired together. If all connected EVs were found, press Enter knob to continue.

## STEP 4A. Choose Unit Base Name

\_\_\_\_\_

UNIT ADDRESS 123  
NAME: Freezer 2A

The Unit being named will have its LED flashing white. Turn knob to change base name: [Freezer, Cooler, Unit, Box]. Push the knob to choose the base name.

## STEP 4B. Choose Unit Suffix

\_\_\_\_\_

UNIT ADDRESS 123  
NAME: Freezer 2A

Turn knob to change unit name suffix: [1A, 1B, ..., 8H]. Push the knob to choose unit name suffix. (Repeat this step with all your EV's as necessary)

## STEP 5. Choose Box Temp Sensor

\_\_\_\_\_

SELECT PRIMARY EV?  
Freezer 2B

If more than 1 Evap was configured, turn knob to change primary evap which will be sensing the box temp. Push knob to choose primary evap.

## STEP 6A. Select if Condensing Unit Wired

\_\_\_\_\_

CU WIRED?  
Yes

Press the knob to select YES, if there is a condensing unit wired to an evaporator.

## STEP 6B. Select EV wired to Condensing Unit

\_\_\_\_\_

CU WIRED TO EV?  
Freezer 2A

Turn the knob to select the evaporator wired to the condensing unit. Press the knob to choose the evaporator.

# QUICK SETUP FROM iRC UI

## STEP 7. Country

Country field will automatically flash for edit. Turn dial to change country. Push the knob to choose the country.

COUNTRY USA

Country field will automatically flash for edit. Turn dial to change country. Push the knob to choose the country.

## STEP 8. Time Zone

Time Zone field will automatically flash for edit. Turn knob to change time zone. Push the knob to choose the time zone.

TIME ZONE Non-Standard

Time Zone field will automatically flash for edit. Turn knob to change time zone. Push the knob to choose the time zone.

## STEP 9. Daylight Savings

Turn the knob. Push knob to select either Yes or No.

DAYLIGHT SAVINGS? Yes

Turn the knob. Push knob to select either Yes or No.

## STEP 10. Date & Time

Year field will automatically flash for edit. Turn knob to choose year. Push the knob to choose year. Repeat steps with Month, Day, Hours and Minutes

DATE/TIME 2018 Aug 29 23:59

Year field will automatically flash for edit. Turn knob to choose year. Push the knob to choose year. Repeat steps with Month, Day, Hours and Minutes

## STEP 11. Select Defrost Type

Defrost type field will automatically flash for edit. Turn knob to change defrost type selection. Push the knob to choose defrost type.

DEFROST TYPE Low Temp Electric

Defrost type field will automatically flash for edit. Turn knob to change defrost type selection. Push the knob to choose defrost type.

## STEP 12. Select Defrost Style

Defrost style field will automatically flash for edit. Turn knob to change defrost style selection. Push the knob to choose defrost style.

DEFROST STYLE Smart

Defrost style field will automatically flash for edit. Turn knob to change defrost style selection. Push the knob to choose defrost style.

## STEP 13. Select Refrigerant

Refrigerant field will automatically flash for edit. Turn knob to change refrigerant selection. Push the knob to choose refrigerant.

REFRIGERANT R404A

Refrigerant field will automatically flash for edit. Turn knob to change refrigerant selection. Push the knob to choose refrigerant.

## STEP 14. Select Box Temp Set-Point

Box temp setpoint will automatically flash for edit. Turn knob to change box temp setpoint selection. Push the knob to choose box temp setpoint.

BOX TEMP SP 34.5 F

Box temp setpoint will automatically flash for edit. Turn knob to change box temp setpoint selection. Push the knob to choose box temp setpoint.

## STEP 15. Start System

Start System will automatically flash for edit. Push the knob to start the system when ready.

2 UNITS CONFIGURED Start System?

Start System will automatically flash for edit. Push the knob to start the system when ready.